

Description

TELAIO OK JR. | MOD. CRUISER MS3 - SIRIUS MS3
 OK JR. CHASSIS | MOD. CRUISER MS3 - SIRIUS MS3

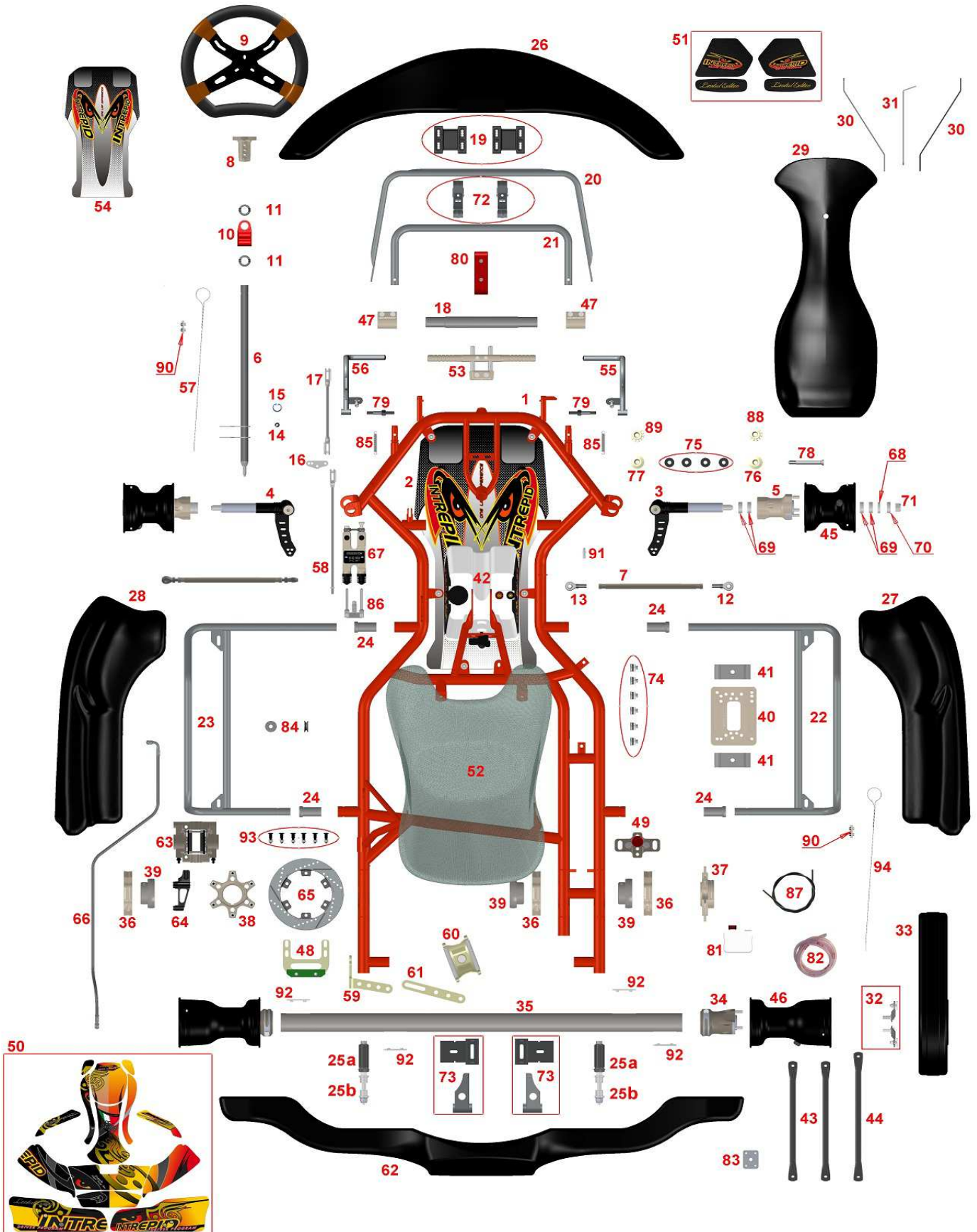

Pos.	Code	Description
1	I/CRMS3-KF-15	SCOCCA CRUISER MS3 OK Ø30mm - 80/CH/20 CRUISER MS3 FRAME OK Ø30mm - 80/CH/20
1A	I/SIRMS3-KF-15	SCOCCA SIRIUS MS3 OK Ø30/32mm - 78/CH/20 SIRIUS MS3 FRAME OK Ø30/32mm - 78/CH/20
2	I/INT0694-06	PIANALE MOD. RACING RACING FLOOR PLATE
3	I/INT1161SHNDX-15	FUSELLO DX Ø25mm 10,25° - H1 - NERO - MOD. 2015 RIGHT SPINDLE Ø25mm 10,25° - H1 - BLACK - MOD. 2015
4	I/INT1161SHNSX-15	FUSELLO SX Ø25mm 10,25° - H1 - NERO - MOD. 2015 LEFT SPINDLE Ø25mm 10,25° - H1 - BLACK - MOD. 2015
5	I/INT1064L95-15	MOZZO ANTERIORE L.95mm - KZ/KF UNIV. cuscinetto Ø25mm - 2015 FRONT HUBS L.95mm - KZ/KF STANDARD bearing Ø25mm- 2015
6	I/INT1039-15	PIANTONE STERZO L. 490MM - MOD. 2015 STEERING COLUMN L. 490mm - MOD. 2015
7A	I/INT0983-07	BARRETTA STERZO L.270mm TITAN-GOLD (CRUISER / RAPTOR) TIE ROD L.270mm TITAN GOLD (CRUISER / RAPTOR)
7B	I/INT0983-15	BARRETTA STERZO L.282mm TITAN-GOLD (SIRIUS) TIE ROD L.282mm TITAN GOLD (SIRIUS)
8	I/ST052TG-08	MOZZO VOLANTE INCLINATO KF/KZ- 3 FORI - TITAN-GOLD KF/KZ INCLINED STEERING WHEEL HUB - 3 HOLES - TITAN-GOLD
9	I/INT0144-05	VOLANTE 4 RAZZE Ø330mm - MOD. RACE UNIVERSALE STEERING WHEEL WITH 4 SPOKES Ø330mm - MOD. RACE UNIVERSAL
10	I/ST079RS-05	SUPPORTO PER PIANTONE STERZO - NYLON - 2FORI - ROSSO STEERING COLUMN SUPPORT - NYLON - 2 HOLES - RED
11	I/ST001TG-08	ANELLO DI FERMO PIANTONE COMPLETO DI GRANI - TITAN-GOLD STEERING LOCKING COLUMN BUSH TITAN GOLD
12	I/ST110DX-05	UNIBALL M8 DX - AC RIGHT UNIBALL M8 - AC
13	I/ST110SX-05	UNIBALL M8 - SX - AC LEFT UNIBALL M8 - AC
14	I/ST046-05	UNIBALL PIANTONE STERZO PB8 UNIBALL FOR STEERING COLUMN PB8
15	I/ST051-05	SEEGER Ø22mm PER UNIBALL PIANTONE STERZO SNAP RING Ø22mm FOR STEERING COLUMN UNIBALL
16	I/LAMATF	LAMA RINVIO TIRANTE FRENO BLADE FOR BRAKE TIE ROD
17	I/TFM6P	TIRANTE FRENO LATO PEDALE M6 BRAKE TIE ROD M6 FOR PEDAL
18	I/INT0970-07	BARRA STABILIZZATRICE Ø28mm ANT. - NYLON NYLON FRONT STABILIZER ROD Ø28mm
19	I/AFS.00036	PLACCA FISSAGGIO SPOILER ANT. NA2 (2 PZ.) FASTENING PLAC FOR FRONT SPOILER NA2 (2 PZ.)
20	I/INTPASNA2	PARAURTI ANTERIORE SUPERIORE MOD. NA2 - CROMATO HIGHT FRONT BUMPER MOD. NA2 - CHROMIUM PLATED
21	I/INTPAINA2	PARAURTI ANTERIORE INFERIORE MOD. NA2 - CROMATO LOW FRONT BUMPER MOD. NA2 - CHROMIUM PLATED
22	I/SCO.0095D	SUPPORTO PARAURTI LAT. NA2 DX RIGHT BODYWORK SUPPORT NA2
23	I/SCO.0095S	SUPPORTO PARAURTI LAT. NA2 SX LEFT BODYWORK SUPPORT NA2
24	I/INT0662-06	BOCCOLA IN TEFLON PER ATTACCO PARAURTI LATERALE FASTENING WASHER IN TEFLON FOR LATERAL BUMPER
25A	I/INT0677TG-08	KIT ATTACCO PARAURTI POST. Ø30mm (CRUISER / RAPTOR) REAR BUMPER FASTENING KIT Ø30 (CRUISER / RAPTOR)
25B	I/INT0678TG-08	KIT ATTACCO PARAURTI POST. Ø32mm (SIRIUS) REAR BUMPER FASTENING KIT Ø32mm (SIRIUS)
26	I/AFS.01617	SPOILER ANTERIORE NA2 - NERO FRONT SPOILER NA2 BLACK

Pos.	Code	Description
27	I/AFS.1618D	CARENATURA LATERALE NA2 DX - NERO RIGHT SIDE BODYWORK NA2 - BLACK
28	I/AFS.1618S	CARENATURA LATERALE NA2 SX - NERO LEFT SIDE BODYWORK NA2 - BLACK
29	I/AFS.01616	FRONTALINO NA2 CIK FIA - NERO NASSAU PANEL NA2 CIK FIA - BLACK
30	I/INT0819-06	COPIA SUPPORTO SUPERIORE FRONTALINO UPPER COUPLE FOR NUMBER PLATE HOLDER
31	I/INT1009-07	SUPPORTO INFERIORE FRONTALINO LOW SUPPORT FOR NUMBER PLATE HOLDER
32	I/INT2013-06	SUPPORTO PARACATENA KF CARTER CHAIN GUARD SUPPORT
33	I/AR712-07	PARACATENA CARTER CHIUSO CARTER CHAIN GUARD
34	I/INT1034L95-08	MOZZO POST. ALLUMINIO Ø50X95mm TITAN-GOLD REAR HUB Ø50X95mm TITAN-GOLD
35	I/INT2-30	ASSALE Ø50 - 1030mm MOD. T2 - MEDIUM ***STANDARD AXLE Ø50 - 1030 MOD. T2 - MEDIUM ***STANDARD
36	I/INT1035-15	GUSCIO PORTACUSCINETTO Ø40-50mm - TITAN-GOLD MOD. 2015 BEARING BUSH SUPPORT Ø40-50mm - TITAN-GOLD MOD. 2015
37	I/INT1036-15	PORTACORONA Ø50mm - TITAN-GOLD MOD. 2015 SPROCKET SUPPORT Ø50mm - TITAN-GOLD MOD. 2015
38	I/INT1037-15	PORTADISCO Ø50mm TITAN-GOLD MOD. 2015 DISK SUPPORT Ø50 mm TITAN-GOLD MOD. 2015
39	I/CU017-08	CUSCINETTO PER ASSALE Ø50X80mm / 3 GRANI AXLE'S BEARING Ø50X80mm / 3 PINS
40	I/INT0995-07	PIASTRA MOTORE AL Ø30X92mm ENGINE MOUNT Ø30X92mm
41	I/PM031-05	CAVALLOTTO UNIVERSALE Ø28/30/32X92mm - AL. UNIVERSAL BRACKET Ø28/30/32X92mm - AL.
42	I/AR277-05-KF	SERBATOIO KF 8,5L COMPLETO KF TANK L8,5 COMPLETE
43	I/AR755-09	RINFORZO SEDILE TONDO L.320mm - CROMATO CHROMED ROUND SEAT SUPPORT L.320mm
44	I/AR756-09	RINFORZO SEDILE TONDO L.340mm - CROMATO CHROMED ROUND SEAT SUPPORT L.340mm
45	I/CE104MG-10	CERCHIO ANTERIORE L.132 CON FORI - LINEA MAGNESIO MAGNESIUM FRONT RIMS Ø132 WITH HOLES - MAGNESIUM LINE
46	I/CE103MG-10	CERCHIO POSTERIORE L.212 CON FORI - LINEA MAGNESIO MAGNESIUM REAR WHEEL RIM H212mm WITH HOLES - MAGNESIUM LINE
47	I/AR197ALTG-08	FASCETTA STRINGITUBO Ø28mm - AL - TITAN-GOLD TIGHTENING PIPE BELT Ø28mm - AL - TITAN-GOLD
48	I/INT1135-09	PROTEZIONE DISCO FRENO POSTERIORE REAR BRAKE DISC PROTECTOR KIT
49	I/INT1094-08	SPINGIMOTORE COMPLETO CHAIN STRETCHER
50	I/INT1129-08-NA2	KIT ADESIVI CARENATURE NA2 NA2 COMPLETE STICKERS KIT
51	I/INT1130-08	KIT ADESIVI SERBATOIO STICKERS KIT FOR FUEL TANK
52	I/INT0896-06	SEDILE MOD. RACING SILVER SEAT MOD. RACING SILVER
53	I/INT0992-07	SISTEMA POGGIPIEDI REGISTRABILE ADJUSTABLE FOOTREST SYSTEM
54	I/INT0971-07	ADESIVO INTREPID PER PIANALE STICKER FOR FLOOR PLATE
55	I/INT0967-07	PEDALE ACCELERATORE - CROMATO CHROMED ACCELERATOR PEDAL

Pos.	Code	Description
56	I/INT0968-07	PEDALE FRENO - CROMATO CHROMED BRAKE PEDAL
57	I/FR354-05	KIT COMPLETO TIRANTE FRENO KF - M6X410 CHROMED TIE ROD KF - M6X410
58	I/FR106-05	CAVO DI SICUREZZA L.410mm - KF SAFETY CABLE L. 410mm - KF
59	I/INT1118-08	SUPPORTO CULLA MARMITTA SX LEFT SILENCER HOLDER
60	I/AR181-05	CULLA MARMITTA COMPLETA DI MOLLE COMPLETE SILENCER HOLDER
61	I/INT1120-08	STAFFA PER SUPPORTO CULLA MARMITTA SUPPORT BRACKET FOR SILENCER HOLDER
62	I/AR608-06	SPOILER POST. CIK/14 - NERO PLASTIC REAR BUMPER CIK/14 - BLACK
63	I/INT1052-08	PINZA FRENO POSTERIORE R1/R2/FRM.R1 REAR BRAKE CALIPER R1/R2/FRM.R1
64	I/SPP-R1/R2K	SUPPORTO PINZA POSTERIORE R1K/R2K - AL- NERO REAR BRAKE CALIPER SUPPORT R1K/R2K - AL- BLACK
65	I/DFP-R1/R2K	DISCO FRENO POSTERIORE R1K/R2K/R1/R2 REAR BRAKE DISC R1K/R2K/R1/R2
66	I/KITFR-P	KIT TUBO FRENO POST. R1K/R2K REAR BRAKE PIPE R1K/R2K
67	I/PF17-20	POMPA FRENO DOPPIO CORPO Ø17mm R1K/R2K R1K/R2K BRAKE PUMP Ø17mm WITH DOUBLE BODY
68	I/FS036-06	SPESSORE FUSELLO Ø25X6mm - GIALLO SPINDLE LINING Ø25X6mm - YELLOW
69	I/FS037-06	SPESSORE FUSELLO Ø25X10mm - GIALLO SPINDLE LINING Ø25X10mm - YELLOW
70	I/FS038-06	RONDELLA Ø25mm PER CHIUSURA MOZZO STEEL WASHER Ø25mm FOR HUB LOCKING
71	I/FS008-05	DADO M14X1,5mm AUTOBLOCCANTE SELFLOCKING NUT M14X1,5mm
72	I/INT2013-01	KIT GANCI ATTACCO SPOILER ANTERIORE 2 PZ. CLAMP KIT FOR FRONT SPOILER 2 PZ.
73	I/INT2013-02	KIT SUPPORTO PARAURTI POST. 2 PZ. SUPPORT KIT FOR REAR BUMPER 2 PZ.
74	I/INT2013-03	KIT VITI CON GOMMINO PER FISSAGGIO PIANALE 6 PZ. SCREW KIT WITH RUBBER WASHER FOR FLOOR PLATE 6 PZ.
75	I/INT0734-06	RONDELLA PER REGOLAZIONE FUSELLO Ø10 HIGH REGULATION SPINDLE WASHER Ø10
76	I/INT0956-07	BOCCOLA DRITTA SUPERIORE UPPER STRAIGHT BUSH
77	I/INT0957-07	BOCCOLA DRITTA INFERIORE LOWER STRAIGHT BUSH
78	I/INT0794-06	VITE FUSELLO Ø10 - SPECIALE RETTIFICATA SPINDLE SCREW Ø10 - SPECIAL WITH GRINDING
79	I/INT2013-04	VITE ATTACCO PEDALE PEDAL'S SREW
80	I/INT2013-05	COPPIA FISSAGGIO PARAURTI ANT. - PLASTICA - ROSSA 2 PZ. COUPLE OF JOINTS FOR FRONT SPOILER - PLASTIC - RED 2 PZ.
81	I/INT2013-09	SERBATOIO DI RECUPERO RECOVER TANK
82	I/AR078-05	TUBO BENZINA Ø5X10mm - MT. 1 FUEL PIPE - Ø6X9mm - EACH METER
83	I/INT2013-07	PIASTRINA ATTACCO SEDILE - ALLUMINIO SEAT'S PLATE CONNECTION - ALUMINIUM
84	I/AR216TG-05	SPESSORE SEDILE Ø30XØ10X10mm - ALLUMINIO SEAT LINING Ø30XØ10X10mm - ALUMINIUM

Pos.	Code	Description
85	I/AR093-05	MOLLA PEDALE ZINCATA <i>PEDAL SPRING - GALVANIZED</i>
86	I/GRPR1-2K	GRUPPO PUNTALI POMPA FRENO R1K-2WP/R2K <i>COMPLETE PUMP'S PUSH RODS R1K-2WP/R2K</i>
87	I/AR140NR-05	GUAINA PER CAVO ACCELERATORE - COL. NERO <i>ACCELERATORE SHEATH WIRE - BLACK</i>
88	I/INT1010-07	BOCCOLA ECCENTRICA SUPERIORE 1° - GIALLA <i>UPPER HEAD ECCENTRIC BUSH 1° - YELLOW</i>
89	I/INT1011-07	BOCCOLA ECCENTRICA INFERIORE 1° - GIALLA <i>LOWER HEAD ECCENTRIC BUSH 1° - YELLOW</i>
90	I/AR487-05	MORSETTO A 2 VITI PER CAVO ACCELERATORE <i>2 SCREW CLAMP FOR ACCELERATOR AND CLUTCH WIRE</i>
91	I/AR137-05	REGISTRO M6X30mm PER GUAINA <i>M6X30mm REGISTER FOR SHEATH</i>
92	I/CH017-05	CHIAVETTA A 2 PIOLI <i>REAR AXLE KEY 2 PIVOT</i>
93	I/INT1091-15	KIT POST. BOCCOLE FLOTTANTI PORTADISCO R1K/R2K (6 PZ) <i>DISK SUPPORT R1K/R2K COMPLETE FLOATING BUSH KIT (6 PZ)</i>
94	I/AR196-05	FILO AC 1,2X2000mm TIPO SVEDESE PER ACCELERATORE <i>1,2X2000mm - STEEL ACCELERATOR WIRE SWEDISH</i>